

Bonjour à l'initiative



PALMER JOHNSON

for



Two iconic and admired brands have combined their pedigree in design, technology and performance into a fearless vision for the future of sport yachts. One that transcends dogma by simply thinking not just outside the box, but without a box. Inspired by the amazing Bugatti Chiron, the outcome of this powerful alchemy between Palmer Johnson and Bugatti is the **Limited Edition Niniette**.

Jose Bugatti



Bugatti Chiron June 16



Bugatti FS 66 Nimette open sport

The Bugatti line is effortlessly integrated into the design of the Chiron and Niniette. It makes them unmistakably a Bugatti.

A SHARED
DNA

UNIQUE AND ICONIC.

AN ELEGANT EXPRESSION OF A SPORT YACHT.







**A COMMITMENT TO CRAFTSMANSHIP.
THAT YOU CAN SEE, TOUCH AND EXPERIENCE.**





**ELEGANT SYMMETRY.
CAPTIVATING SHAPES.**

THE
RETRACTABLE
HOOD







*"if comparable...
... it is no longer Bugatti"*



Ettore Bugatti





*Adding new
dimensions*

YOUR **PRECIOUS** SANCTUARY



Polished modernism and sumptuous comfort are balanced in perfect harmony. The interior lounge pays subtle tribute to Bugatti's automotive heritage whilst retaining a luxury that cocoons you in a mixture of precious materials.

MODERN AND TIMELESS LUXURY.



**YOUR
ULTIMATE
RETREAT**



Some places are memorable. The Niniette master suite is unforgettable. An inner sanctum like no other, the beauty of its interior resides in the sustained harmony of opposites – soft leather against polished metal; suede against carbon.

POWERFULLY SEDUCTIVE.



PERFORMANCE

Advanced stabilised hull achieves speed with efficiency and amazing comfort.

The super slim hull provides higher speeds with lower input power and fuel burn.

Side sponsons offer additional vessel beam and increased stability at rest.



LAYOUT AND SPECIFICATIONS

SPECIFICATION

Hull Type:	Stabilised Monohull with Sponsons
Naval Architecture & Engineering:	Palmer Johnson
Exterior Styling & Interior Design:	Bugatti, Palmer Johnson and A++
Classification:	CE Category B
Material of Hull & Deck:	Carbon Composite

PRINCIPAL CHARACTERISTICS

Length Overall:	20m
Beam:	6.5m
Max Draft Inc Props:	0.83m

PROPULSION and TECHNICAL DETAILS

Main Engines:	2 x MAN V8 + Waterjets
Maximum Speed:	44 Knots
<i>(Trial condition – options not included)</i>	
Fuel Capacity:	3000 Litres

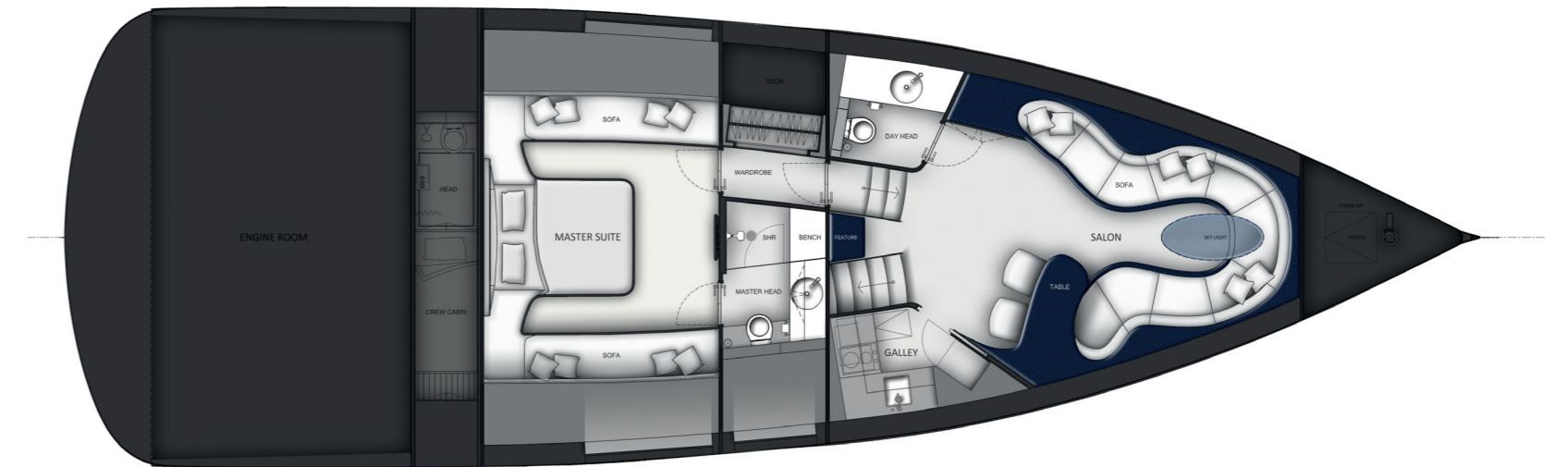
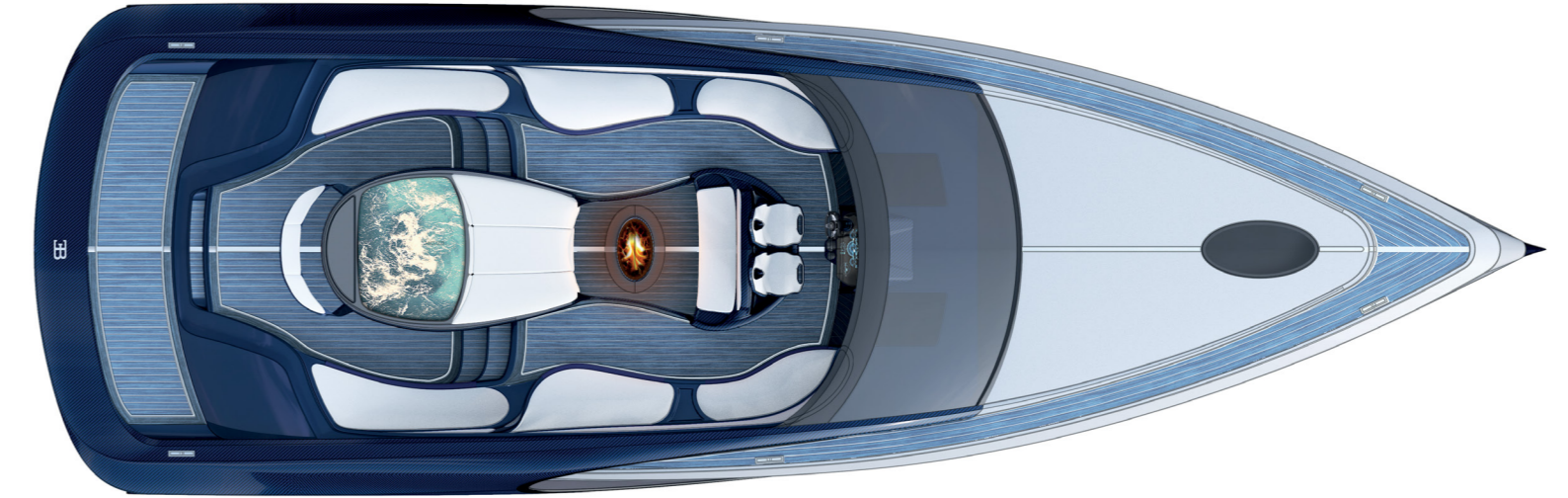
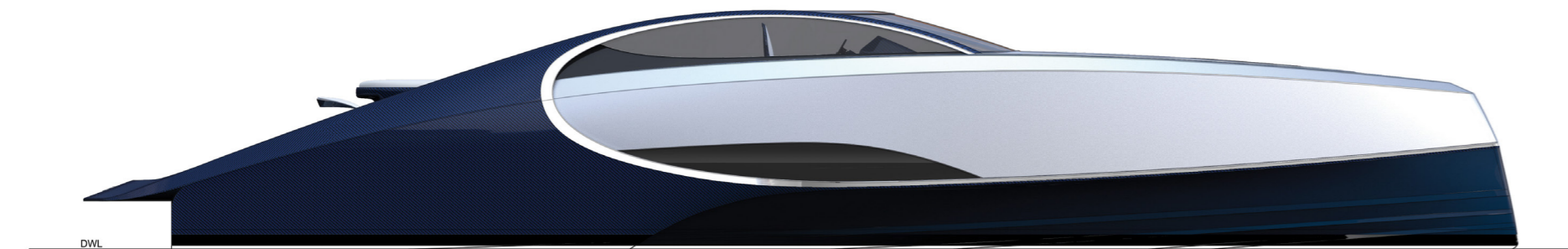



PALMER JOHNSON

Heritage • Performance • Design



SALES ENQUIRIES

Palmer Johnson
Monaco
T: + 377 99 99 40 30
M: +33 6 07 93 24 24
E: sales@palmerjohnson.com
www.palmerjohnson.com

